

JACK!E™

ROSE QUARTZ & SERENITY COLLECTION

Butterfly Quilt (Q-015B)

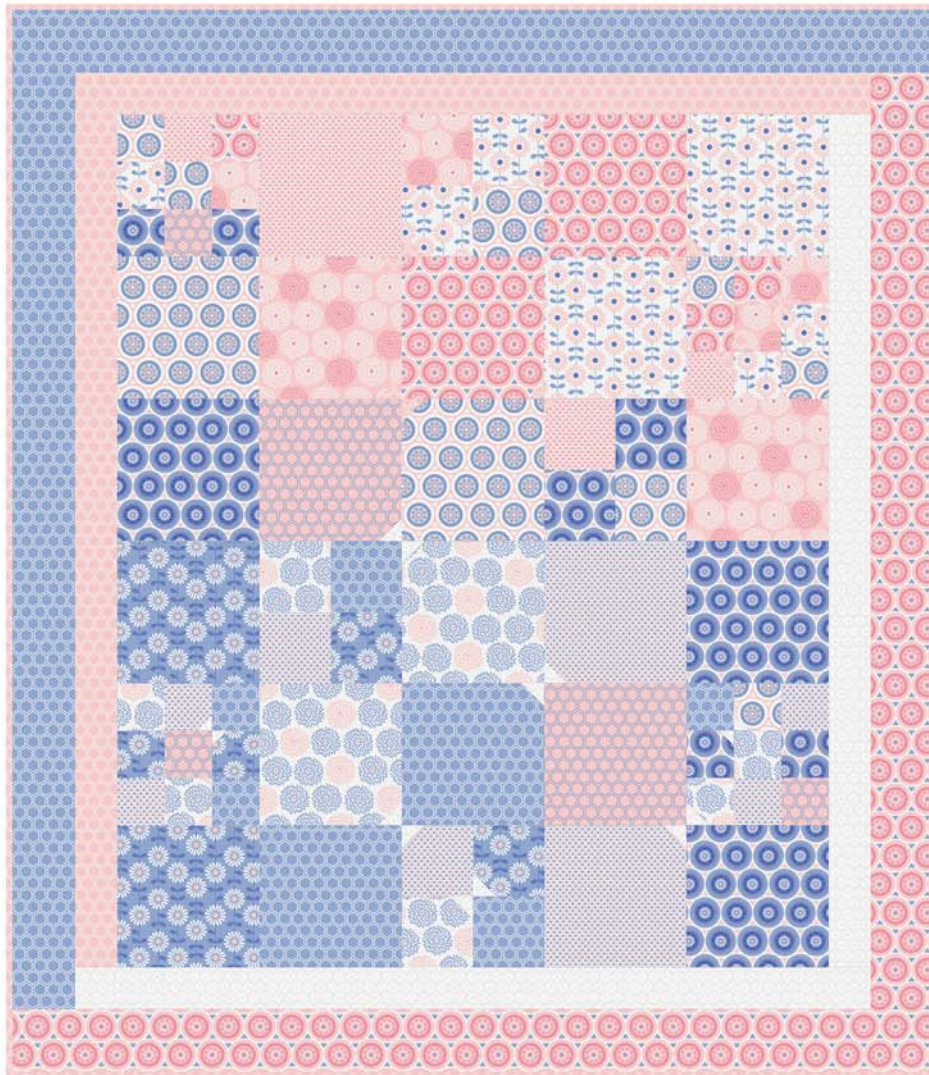

Exclusive Quilt Design by Melissa Stramel of Lilac Lane Patterns for Camelot Fabrics.
Fabric collection: Rose Quartz & Serenity by Jackle McFee for Camelot Fabrics
The direction of the fabrics in the digital imagery may not be accurate to the final product.



Fabric requirements

- | | |
|--|--|
| 
Fabric A: 4142105 #2
1-1/3 yards
(includes binding) | 
Fabric B: 2142-0001
2/3 yards |
| 
Fabric C: 4142105 #3
1-1/4 yards | 
Fabric D: 4142104 #2
1 yard |
| 
Fabric E: 4142104 #1
5/8 yard | 
Fabric F: 4142102 #2
1/2 yard |
| 
Fabric G: 4142104 #3
2/3 yard | 
Fabric H: 4142101 #1
1/2 yard |
| 
Fabric I: 4142102 #1
5/8 yard | 
Fabric J: 4142103 #1
5/8 yard |
| 
Fabric K: 4142101 #3
1/2 yard | 
Fabric L: 4142105 #1
1/2 yard |
| 
Fabric M: 4142103 #2
1/2 yard | 
Suggested Backing:
4142103 #3
5-1/4 yards |

Finished quilt size: 76" x 88"
Difficulty: Beginner



Blog, Facebook, Twitter @CamelotFabrics
Pinterest, YouTube & Instagram @Camelot_Fabrics
camelotfabrics.com • camelotfabricsblog.com
Toll-Free: 1-800-361-4120 • 514-382-2400
info@camelotfabrics.com • www.camelotfabrics.com

Other Supplies

- rotary cutter & fabric shears
- sewing machine
- iron & pressing surface
- needle & coordinating thread
- measuring tape/ruler

Notes

- Please wash, dry & iron your fabric before beginning, and trim your selvages.
- Use the quilt layout on cover page as your guide for all block composition.
- WOF = width of fabric.
- Use a 1/4in. seam allowance for all seams.
- Press your seams as you go; press open or toward the darker fabric, whichever you prefer.

Cutting

Fabric A

Cut (4) strips 3-1/2in. x WOF (42in.-44in.).

Join end-to-end in pairs and trim one to 72-1/2in. long, the second to 66-1/12in. long

Cut (9) strips 2-1/2 in. x WOF for binding

Cut (1) strip 4in. x WOF – sub-cut (8) 4in. squares

Cut (1) 2in. x WOF strip – sub-cut (8) 2 in. squares

Fabric B

Cut (4) strips 3-1/2in. x WOF (42in. -44in.).

Join end-to-end in pairs and trim one to 72-1/2 in. long, the second to 66-1/12 in. long

Cut (1) strip 4in. x WOF – sub-cut (10) 4 in. squares.

Cut (1) strip 2in x WOF – sub-cut (4) 2 in. squares

Fabric C

Cut (4) strips 5-1/2in. x WOF. Join end-to-end in pairs and trim one to 78-1/12 in. long, the second to 76-1/2 in.

Cut (1) strip 12-1/2 in. – sub-cut (2) 12-1/2 in. squares.

Sub-cut remaining strip to 6-1/2 in. and sub-cut (2) 6-1/2 in. squares.

Cut (1) strip 4-1/2 in. x WOF – sub-cut (3) 4-1/2 in. squares

Fabric D

Cut (4) strips 5-1/2in. x WOF. Join end-to-end in pairs and trim one to 78-1/2 in. long, the second to 76-1/2 in.

Cut (1) strip 12-1/2in. x WOF. Sub-cut (2) 12-1/2 in. squares.

Sub-cut remain strip to 4-1/2 in. Sub-cut to (3) 4-1/2 in. squares.

Fabric E

Cut (1) strip 12-1/2in. x WOF. Sub-cut (2) 12-1/2 in. squares

Sub-cut remaining strip to 6-1/2 in. and sub-cut (2) 6-1/2 in. squares.

Cut (1) strip 4-1/2 in. x WOF – sub-cut (5) 4-1/2 in. squares

Fabric F

Cut (1) strip 12-1/2in. x WOF. Sub-cut (2) 12-1/2 in. squares

Sub-cut remaining strip to 6-1/2 in. and sub-cut (1) 6-1/2 in. square.

Cut (1) 4-1/2in. strip. Sub- cut (3) 4-1/2 in. Squares.



Fabric G

Cut (1) strip 12-1/2in. x WOF. Sub-cut (3) 12-1/2 in. squares

Cut (1) strip 6-1/2 in. Sub – cut (2) 6-1/2 in. squares

Sub-cut- remaining strip to 4-1/2 in. Sub-cut to (4) 4-1/2 in. square.

Fabric H

Cut (1) strip 12-1/2in. x WOF. Sub-cut (2) 12-1/2 in. squares

Sub-cut remaining strip to 6-1/2 in. and sub-cut (2) 6-1/2 in. squares

Cut (1) 4-1/2in. strip. Sub- cut (3) 4-1/2 in. Squares.

Fabric I

Cut (1) strip 12-1/2in. x WOF. Sub-cut (2) 12-1/2 in. squares

Sub-cut remaining strip to 6-1/2 in. and sub-cut (2) 6-1/2 in. squares

Cut (1) 4-1/2in. strip. Sub- cut (4) 4-1/2 in. Squares.

Fabric J

Cut (1) strip 12-1/2in. x WOF. Sub-cut (2) 12-1/2 in. squares

Sub-cut remaining strip to 6-1/2 in. and sub-cut (2) 6-1/2 in. squares

Cut (1) 4-1/2in. strip. Sub- cut (4) 4-1/2 in. Squares.

Fabric K

Cut (1) strip 12-1/2in. x WOF. Sub-cut (2) 12-1/2 in. squares

Sub-cut remaining strip to 6-1/2 in. and sub-cut (2) 6-1/2 in. squares

Cut (1) 4-1/2in. strip. Sub- cut (2) 4-1/2 in. Squares.

Fabric L

Cut (1) strip 12-1/2in. x WOF. Sub-cut (2) 12-1/2 in. squares

Sub-cut- remaining strip to 4-1/2 in. Sub-cut to (3) 4-1/2 in. squares

Fabric M

Cut (1) strip 12-1/2in. x WOF. Sub-cut (1) 12-1/2 in. squares

Sub-cut remaining strip to 6-1/2 in. and sub-cut (1) 6-1/2 in. square

Sub-cut- remaining strip to 4-1/2 in. Sub-cut to (2) 4-1/2 in. squares

A & B fabric squares will be used to make butterfly wings (4in. squares = large wings,

2in. squares = small wings)

You should have the following:

A-8 Large, 8 Small

B-10 Large, 4 Small

Squares from fabrics C,D,E,F,G,H,I,J, K,L, M will be used to build the blocks.

[12-1/2in = Large squares (L), 6-1/2" = Medium-sized squares (M), 4-1/2" = Small squares (S)]

You should have the following:

C-2L, 2M, 3S

D-2L, 3S

E-2L, 2M, 5S

F-2L, 1M, 3S

G-3L, 2M, 4S

H-2L, 2M, 3S

I-2L, 2M, 4S

J-2L, 2M, 4S

K-2L, 2M, 2S

L-2L, 3S

M-1L, 1M, 2S

Add wings to squares in the following manner: (note: SA-SM = sew Small A square to Small M square)

SA-SM (LOWER RIGHT CORNER)

SA-SF (UPPER LEFT CORNER)

SA-MF (LOWER RIGHT)

SA-ME UPPER LEFT

LA-MH LOWER LEFT

LA-LH LOWER LEFT

LA-LF LOWER RIGHT & LA UPPER RIGHT

SA-LD LOWER RIGHT

LA-LH UPPER RIGHT

SA-SD LOWER RIGHT

LA-SF LOWER LEFT

SA-SH UPPER LEFT

LA-SM UPPER RIGHT

LB-LL LOWER RIGHT

LA-LE UPPER RIGHT

SA-MM UPPER LEFT

LB-LI UPPER LEFT

LB-LJ LOWER LEFT

SB-SJ LOWER RIGHT

SB-SK UPPER LEFT

LB-LI LOWER RIGHT

LB-LC UPPER RIGHT

SB-SE LOWER LEFT

SB-SG UPPER RIGHT

LB-SI LOWER LEFT

LB-MJ UPPER LEFT

LB-MK LOWER LEFT

LB-MI UPPER RIGHT

LB-LJ UPPER RIGHT



Assembly

Butterfly Wings

We're using a small wing in our examples, but the method for adding the butterfly wings is the same for all wing/square combinations.

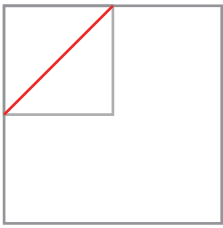

1. Place a small square (Fabric A or B) on top of a larger square (Fabrics E to M) as shown, Right Sides together. Draw a diagonal line between two opposite corners of the smaller square.

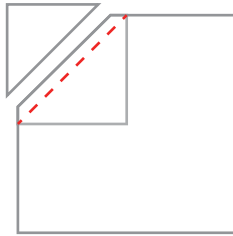

2. Sew along the marked line and trim the excess, leaving a 1/4in. seam allowance.

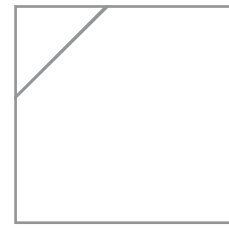

3. Open up your work and press the seam open.

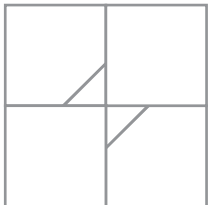

Good

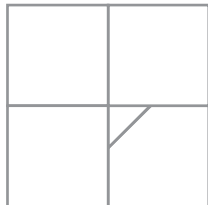

No Good

9-Patch Blocks

When assembling the quilt, take care that each half-wing has a matching half-wing across from it as shown in the quilt layout on the last page.

4. Referring to the quilt layout on page 1, sew the 4-1/2in. squares together in rows of three.

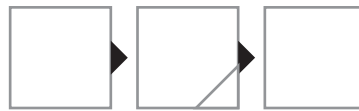

5. Sew the rows together to make a 12-1/2" square block

Make (4) 9-patch blocks measuring 12-1/2" x 12-1/2".

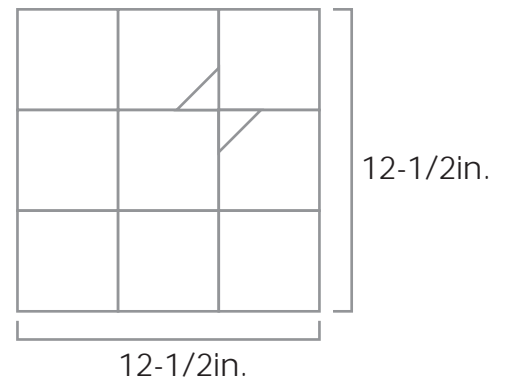

4-Patch Blocks

6. Referring to the quilt layout on page 1, sew the 6-1/2" squares together in 2 rows of two.

Make (4) 4-square blocks, finished size 12-1/2in. square.

7. Sew the rows together to make a 12-1/2" square block.

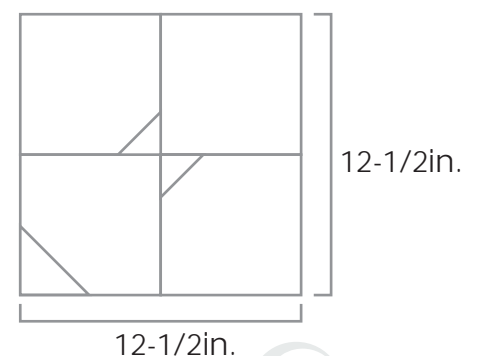
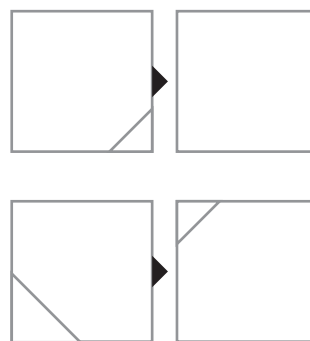

Make (4) 4-patch blocks measuring 12-1/2 x 12-1/2".

You should now have the following (30) 12-1/2" units:

(4) 9-patch blocks

(4) 4-patch blocks

(22) 12-1/2" squares

8. Sew the 12-1/2in. blocks together in rows of (5), according to the quilt layout on page 1.

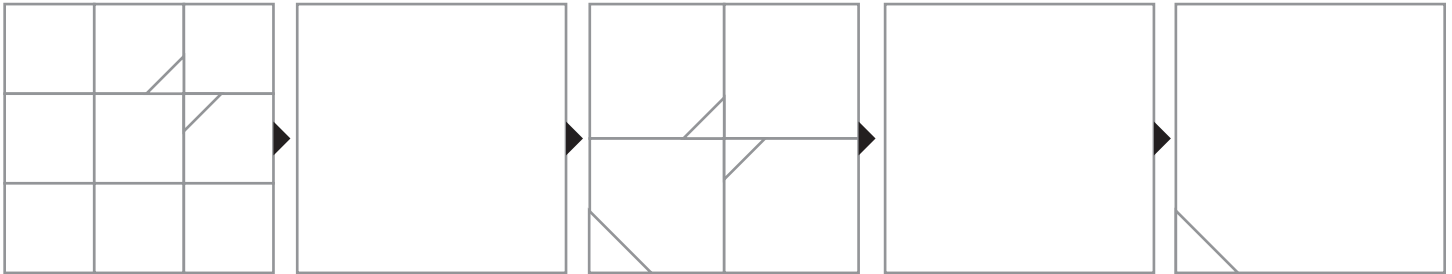

9. Sew the (6) 5-block rows together to complete the center of the quilt.

Adding the Borders - please see the diagram on the following page.

10. Sew one Fabric A border (3-1/2 in. x 72-1/2in.) to the left-hand side of the quilt center.

11. Sew 1 Fabric B border (3-1/2 in. x 72-1/2in.) to the right-hand side of the quilt center.

12. Sew one Fabric A border (3-1/2 in. x 66-1/2in.) to the top of the quilt center.

13. Sew 1 Fabric B border (3-1/2 in. x 66-1/2in.) to the bottom of the quilt center.

14. Sew one Fabric C border (5-1/2 in. x 78-1/2in.) to the left-hand side of the quilt center.

15. Sew 1 Fabric D border (5-1/2 in. x 78-1/2in.) to the right-hand side of the quilt center.

16. Sew one Fabric C border (5-1/2 in. x 76-1/2in.) to the top of the quilt center.

17. Sew 1 Fabric D border (5-1/2 in. x 76-1/2in.) to the bottom of the quilt center.

18. Following your preferred method, use the 2-1/2in. Fabric A strips to make the binding.

19. Layer the quilt top, batting and backing. Baste and quilt as desired, and trim the excess backing and batting. Bind with the binding created in step 13

Adding the Borders

Please note - "butterflies" are not true to scale.

